

To,

**Subject: Development of NIDM Campus – Expression of Interest for developing
Conceptual Layout Plan**

Sir/Madam,

The National Institute of Disaster Management constituted under the Disaster Management Act 2005 has been entrusted with the nodal responsibility for human resource development, capacity building, training, research, documentation and policy advocacy in the field of disaster management.

2. Approximately 4.7 acres of land is proposed to be transferred to NIDM for development of its campus from the land under the possession of Directorate of Communication and Police Wireless (DCPW) at Transmitting Station, Nizamuddin East, Behind Humayun Tomb. A rough layout of the proposed land to be transferred to NIDM is enclosed.

3. Expression of interest is invited for the following tasks:

- (i) To get the proposed area to be transferred to NIDM surveyed and develop an outline plan clearly showing the existing structures in the earmarked land and site boundaries / adjacent occupancy.
- (ii) To prepare a Conceptual Site Layout showing proposed building structures within the limits of land available based on preliminary requirements of the Institute viz., (i) Training Block, (ii) Administrative Block, (iii) Hostel, (iv) SAARC DM Centre, (v) Residential Block, (vi) Recreational facilities, etc.

4. The expression of interest for the above mentioned tasks with financial offer must reach "The Executive Director", NIDM, 5B, IIPA Campus, I. P. Estate, New Delhi – 110002 latest by 14.08.2012. For details, you may contact the undersigned or Shri J. N. Jha, Engineer, NIDM at 011-23702441 and 9818988769.

Yours truly,

06/8/2012
(Arun Sahdeo)
Consultant

Encl: As above

We the under signed have jointly surveyed/measured the
 End of TX Station Wikanuddin and marked boundary after
 comparison as per Landmap.

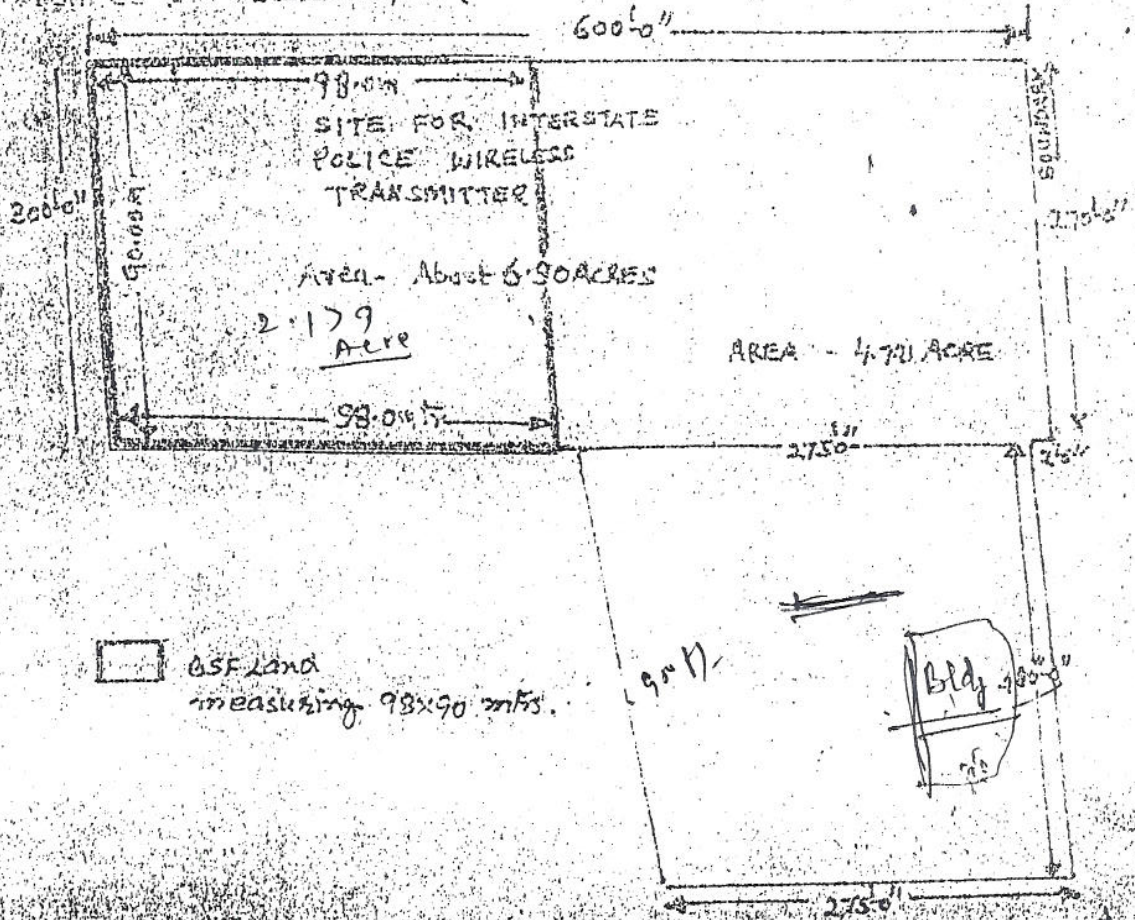

A. S. B. I.
 Extra Assit.
 Co-ordination Post
 New Delhi-110010

BYALA 11/2/99

(Signature)
 (MSPR(T)) KHUSHI PAM...
(Signature)
 (MSPR(T)) KASHMIRA BISHI

(SIT/JE)
 Final
 3.10.1999
 SE
 Engdte

Gund